

# Pinedale Historic District

## 1904-1905

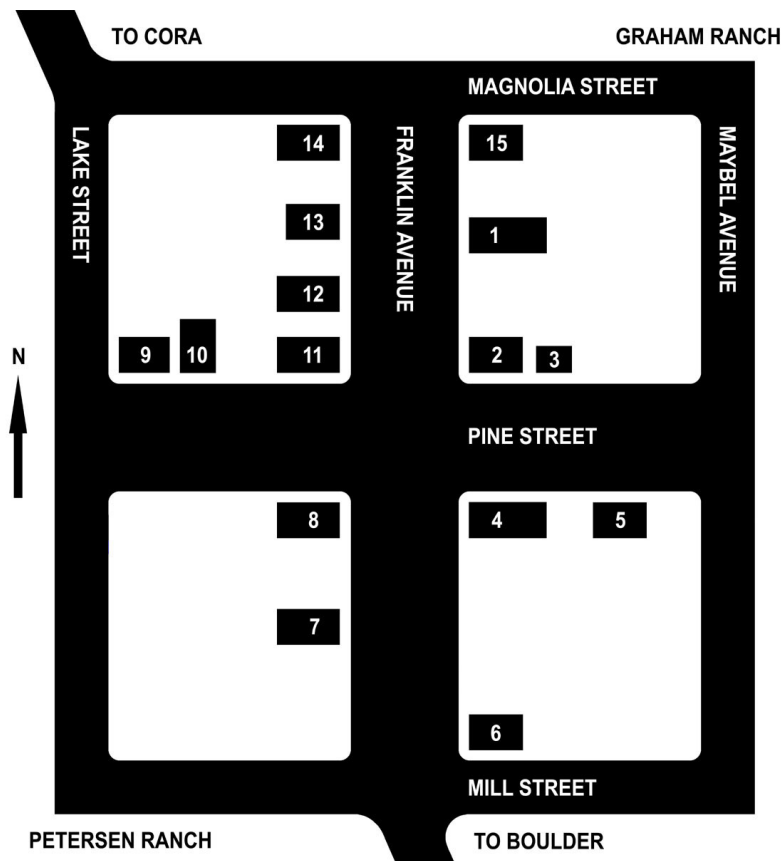

1. Pinedale Hotel  
(only original building)
2. Pinedale Roundup Office  
& Post Office
3. Brandon Meathouse
4. Woodman Hall
5. Bates Photography
6. Pinedale School
7. Truax Blacksmith
8. Sturdevant Drug Store
9. Forest Reserve Office
10. Jones Home
11. Franklin Mercantile Co.
12. Patterson Home
13. Dr. Alexander Building
14. Fremont Saloon
15. Tarter Home

Mr. John F. Patterson, known as the Founder of Pinedale, proposed establishing a town at this location. He offered to build and stock a general store if local ranchers Charles A. Petersen and Mr. Robert O. Graham each donated five acres for the town site. The three gentlemen agreed to this plan, a surveyor was hired, and the town of Pinedale, named after the Post Office on Petersen's ranch, became a town on paper owned by these three. Pine Street was the ranchers' property line. Founders Day is September 26, 1904, when the first town plat was drawn on a piece of yellow linen cloth showing blocks, lots and streets. Free town lots were offered to early settlers, one of whom was C. Watt Brandon, Mr. Patterson's nephew. Mr. Brandon built a newspaper office for his paper, *The Pinedale Roundup*, which also housed the new Post Office.

Sublette County Historic Preservation Board  
September 26, 2004

